



# DIRECTIONS

**From the North:** Take Route 1 South to the Capitol Complex exit. Turn right onto Warren Street and proceed to the light. Turn left onto Market Street. Pass through the next light and bear right. Follow signs for the Capitol Complex.

**From the East:** Take Interstate 195 West to Route 29 North (toward Lambertville). Follow Route 29 North and exit right at Memorial Drive. Proceed through the light at the end of the ramp. Stay to the right and make a semi-circle around the parking area. Go straight at the light and make an immediate left to the Capitol Complex Garage.

**From the South:** Take Route 206 North, or Interstate 295 North, to Route 129. Route 129 feeds into Route 29 North. Exit right at Memorial Drive and follow the directions from the East.

**From the West:** Enter Trenton via the Delaware River toll bridge (Route 1 North). Exit at Route 29 and drive north toward Lambertville. Exit right at Memorial Drive and follow the directions from the East.

PARKING

Specially marked spaces for visitors with special needs are available in the Capitol Complex Parking Garage and on the south side of West State Street between the State House and Thomas Edison State College.



ENTERING THE BUILDINGS

State House Entrance

The West State Street entrance is closed.

State House Annex Entrance

The West State Street entrance to the Annex is equipped with a wheelchair-accessible ramp and power-assisted doors.



Welcome Center

Located behind the State House, the Welcome Center has power-assisted doors.

SECURITY

All visitors should be prepared to show valid identification and go through security screening. Acceptable forms of identification include any government issued photo ID such as a passport, driver's license, or Motor Vehicles Commission issued picture ID.



*THE NEW JERSEY  
STATE HOUSE & ANNEX*

---

# INFORMATION FOR VISITORS WITH SPECIAL NEEDS

---

*New Jersey Legislature  
★ Office of LEGISLATIVE SERVICES ★*

**Office of Public Information**  
State House Annex, P.O. Box 068  
Trenton, New Jersey 08625-0068  
[www.njleg.state.nj.us](http://www.njleg.state.nj.us)

# NEW JERSEY STATE HOUSE & ANNEX ACCESS

New Jersey's State House is one of the oldest capitols in continuous use. Since the original structure was built in 1792, numerous additions and modifications have been made. In 1987, a major renovation restored the legislative portion of the building. Making the historic structure meet barrier-free access requirements was a challenge. In areas where a waiver was granted, alternate arrangements were made to ensure access for every citizen.



## LEGISLATIVE CHAMBERS, OFFICES AND COMMITTEE ROOMS

On session days, sergeants-at-arms are permitted to allow visitors using wheelchairs access to a chamber through the main entrance off the first floor hallway. Legislative Leadership offices, on the second floor of the State House, are accessible by key-operated platform lifts. The keys to both lifts may be obtained from staff in rooms L113, L116 and L214. The legislative chambers and committee rooms are equipped with built-in, ADA-compliant, FM-assisted listening devices for persons with hearing loss. Headsets and receivers are available when requested 24 hours in advance. Specific arrangements can be made by calling:

AD

Legislative Committee Rooms: 609-847-3353  
Senate Chamber: 609-847-3915  
General Assembly Chamber: 609-847-3115

Real-time reporters and sign language interpreters are available with a minimum of five working-days' notice by calling 609-847-3353.

## ELEVATORS

### The State House

Elevators located in the main corridor of the legislative wing service Levels B, 1, 2, 3, and 4 and are wheelchair accessible. The one labeled for handicapped use stops at Level B and avoids the four steps that separate Level B from B1. Please note that this elevator is not reserved solely for visitors with special needs.

### The Annex

Three wheelchair-accessible elevators in the center of the Annex provide access to each of the building's main levels. Sub-levels of the basement and first floor are also serviced by a wheelchair-accessible elevator.

## THE PEDESTRIAN TUNNEL

A Pedestrian Tunnel connecting the State House, Annex and Welcome Center accommodates wheelchair users.

## SIGNAGE

Signage in the Annex and Pedestrian Tunnel contains Braille and raised lettering.

## RESTROOMS

### The State House

Floors A, B1, 1, 2, and 3 have public restrooms that are accessible to visitors with special needs.

### The Annex

Restrooms throughout the Annex have sinks and lavatories that accommodate wheelchair users.



## FOR VISITORS WITH INFANTS

There is a lactation room in the legislative State House adjacent to the 3<sup>rd</sup> floor Women's Room. Nearby Men's and Women's Rooms and those in the Welcome Center have diaper-changing stations.

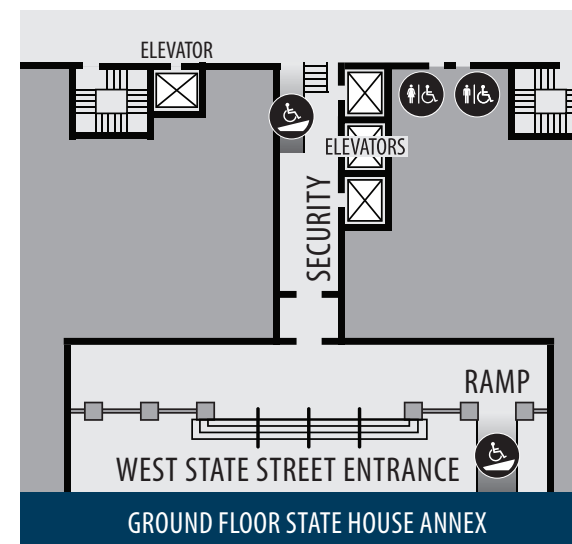
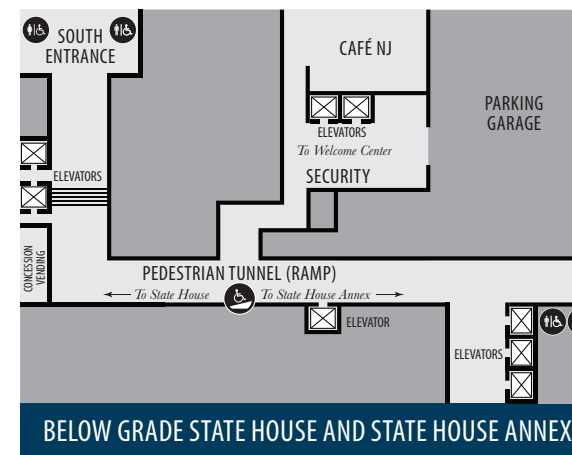

## LEGISLATIVE INFORMATION

Staff from the Office of Legislative Services Legislative Information and Bill Room (located in room B-1 in the basement of the State House Annex) can answer questions regarding the legislative process, legislative activity, the status of bills, legislative committee/ commission membership, and legislative district contact information.

Call: 609-847-3905

Toll free in NJ: 800-792-8630

Hearing impaired: Dial 711 for NJ Relay

## Large Size Print and Audio Materials

Large print versions of bills, resolutions and committee statements can be obtained from the Legislative Information and Bill Room. Upon request, other publications can be reproduced in large print and some items can be transferred onto audio format as well.

Large Print

## TOURS

Because the public galleries are not wheelchair accessible, visitors in wheelchairs are typically allowed on to the chamber floors on non-session days. Advance reservation for this accommodation is appreciated. Tours for the blind and visually impaired, and for visitors with developmental disabilities, require advance reservations. Sign language interpreters are available, provided the request is made at least five days prior to the tour. For tour information and reservations, call the State House Tour Office at 609-847-3150.



**ADDITIONAL INFORMATION** For more information regarding access for visitors with special needs, call the Administrative Unit of the Office of Legislative Services at 609-847-3353.